

SLIP BLOCKS AND INFILL BLOCKS

Insulite & Dense Special Products for Flooring

We produce a range of products for use in beam & block flooring applications to complement our range of Insulite and Dense concrete blocks.

Slip blocks are available for maintaining coursing heights when using 150mm or 225mm T-beams on block wall inner leaves. Split coursing blocks are used for closing the gaps between the beams at the inner leaf. Infill rebated blocks fully close the gap between the beams.



SLIP BLOCKS

Size Length x Width x Height	Material Type	Strength N/mm ²	Density kg/m ³	Blocks per pack
440mm x 100mm x 38mm	Insulite	7.3	1450 - 1550	336
440mm x 100mm x 38mm	Dense Concrete	7.3	1850 - 2100	294
440mm x 140mm x 40mm	Dense Concrete	7.3	1850 - 2100	252
"150" Split Coursing blocks 380mm x 100mm x 38mm	Dense Concrete	7.3	1850 - 2100	304
"225" Split Coursing blocks 380mm x 100mm x 113mm	Dense Concrete	7.3	1850 - 2100	128
Large End Closure Block 505mm x 140mm x 100mm	Dense Concrete	7.3	1850 - 2100	48
Small End Closure Block 205mm x 140mm x 100mm	Dense Concrete	7.3	1850 - 2100	96

Slip blocks are used to maintain coursing height on adjoining masonry wall for 150mm and 225mm high T-beams.

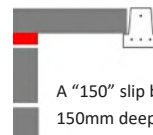

A "150" slip block with a 150mm deep T-beam

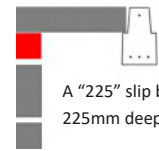

A "225" slip block with a 225mm deep T-beam

380mm long split coursing blocks are used to close the space between the beams at the ends (blocks laid 440mm wide and a 525mm beam spacing).



For a 150mm high beam



For a 225mm beam

REBATED INFILL CLOSURE BLOCKS

Standard Dense Concrete, 7.3 N/mm², 1850 - 2100 kg/m³

Size Length x Width x Height	Blocks per pack	Weight per pack Tonnes
Type G Block (full-depth) 440mm x 140mm x 150mm	72	1.19
Type F Block (full-depth) 215mm x 215mm x 150mm	96	1.15



Type G Block



Type F Block

Good Site Practice & Safe Handling

- Packs should be stored on firm, level ground no more than 2 packs high and protected from severe weather to preserve their quality. Care must be taken when removing the plastic bands as individual blocks may fall out. Never un-band packs above shoulder height.
- In the absence of a revised version of the HSE guidance given in their withdrawn Construction Sheet 37 'Handling Building Blocks' the following principles should be followed: There is a risk of injury in the repetitive handling of blocks heavier than 20kg. Repetitive manual handling of blocks over 20kg should be subject to a risk assessment and a safe system of work should be established before block-laying commences.
- Blocks should not be laid if the temperature is at or below 3°C and falling.
- Blocks should always be laid on a full bed of mortar and vertical joints filled.

NBS Clauses for our concrete block products can be found on www.source.thenbs.com

August 2021



Product details and availability may vary between manufacturing locations. Please contact your nearest regional sales office for sales, product and technical advice.

North East Region :

Tel: 01207 544 214

Fax: 01207 541 800

blocks@thomasarmstrong.co.uk

Cumbria, North Lancashire and Borders Region :

Tel: 01900 68114

Fax: 01900 66136

cumbriablocksales@thomasarmstrong.co.uk

Yorkshire, Humber and Lincolnshire Region :

Tel: 0113 232 0022

Fax: 0113 287 0839

stocks.sales@thomasarmstrong.co.uk

North West, Cheshire, Staffordshire and West Midlands Region :

Tel: 0151 525 5991

Fax: 0151 530 1676

wrsales@thomasarmstrong.co.uk