

# SLIP BLOCKS AND INFILL BLOCKS

Insulite & Dense Special Products for Flooring

**We produce a range of products for use in beam & block flooring applications to complement our range of Insulite and Dense concrete blocks.**

Slip blocks are available for maintaining coursing heights when using 150mm or 225mm T-beams on block wall inner leaves. Split coursing blocks are used for closing the gaps between the beams at the inner leaf. Infill rebated blocks fully close the gap between the beams.



## SLIP BLOCKS

Size Length x Width x Height	Material Type	Strength N/mm <sup>2</sup>	Density kg/m <sup>3</sup>	Blocks per pack
440mm x 100mm x 38mm	Insulite	7.3	1450 - 1550	336
440mm x 100mm x 38mm	Dense Concrete	7.3	1850 - 2100	294
440mm x 140mm x 40mm	Dense Concrete	7.3	1850 - 2100	252
"150" Split Coursing blocks 380mm x 100mm x 38mm	Dense Concrete	7.3	1850 - 2100	304
"225" Split Coursing blocks 380mm x 100mm x 113mm	Dense Concrete	7.3	1850 - 2100	128
Large End Closure Block 505mm x 140mm x 100mm	Dense Concrete	7.3	1850 - 2100	48
Small End Closure Block 205mm x 140mm x 100mm	Dense Concrete	7.3	1850 - 2100	96

Slip blocks are used to maintain coursing height on adjoining masonry wall for 150mm and 225mm high T-beams.

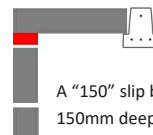

A "150" slip block with a 150mm deep T-beam

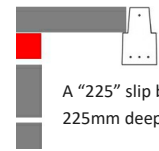

A "225" slip block with a 225mm deep T-beam

380mm long split coursing blocks are used to close the space between the beams at the ends (blocks laid 440mm wide and a 525mm beam spacing).

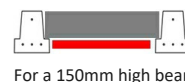

For a 150mm high beam



For a 225mm beam

## REBATED INFILL CLOSURE BLOCKS

Standard Dense Concrete, 7.3 N/mm<sup>2</sup>, 1850 - 2100 kg/m<sup>3</sup>

Size Length x Width x Height	Blocks per pack	Weight per pack Tonnes
<b>Type G Block (full-depth)</b> 440mm x 140mm x 150mm	72	1.19
<b>Type F Block (full-depth)</b> 215mm x 215mm x 150mm	96	1.15



Type G Block



Type F Block

## Good Site Practice & Safe Handling

- Packs should be stored on firm, level ground no more than 2 packs high and protected from severe weather to preserve their quality. Care must be taken when removing the plastic bands as individual blocks may fall out. Never un-band packs above shoulder height.
- In the absence of a revised version of the HSE guidance given in their withdrawn Construction Sheet 37 'Handling Building Blocks' the following principles should be followed: There is a risk of injury in the repetitive handling of blocks heavier than 20kg. Repetitive manual handling of blocks over 20kg should be subject to a risk assessment and a safe system of work should be established before block-laying commences.
- Blocks should not be laid if the temperature is at or below 3°C and falling.
- Blocks should always be laid on a full bed of mortar and vertical joints filled.
- Do not wet the blocks before laying. Where necessary, adjust the consistency of the mortar to suit the suction of the block.
- Blocks are not suitable for unfinished external applications.

November 2020



Product details and availability may vary between manufacturing locations. Please contact your nearest regional sales office for sales, product and technical advice.

North East Region :

Cumbria, North Lancashire and Borders Region :

Yorkshire, Humber and Lincolnshire Region :

North West, Cheshire, Saffordshire and West Midlands Region :

Tel: 01207 544 214

Tel: 01900 68114

Tel: 0113 232 0022

Tel: 0151 525 5991

Fax: 01207 541 800

Fax: 01900 66136

Fax: 0113 287 0839

Fax: 0151 530 1676

blocks@thomasarmstrong.co.uk

cumbriablocksales@thomasarmstrong.co.uk

stocks.sales@thomasarmstrong.co.uk

wrainford@thomasarmstrong.co.uk